

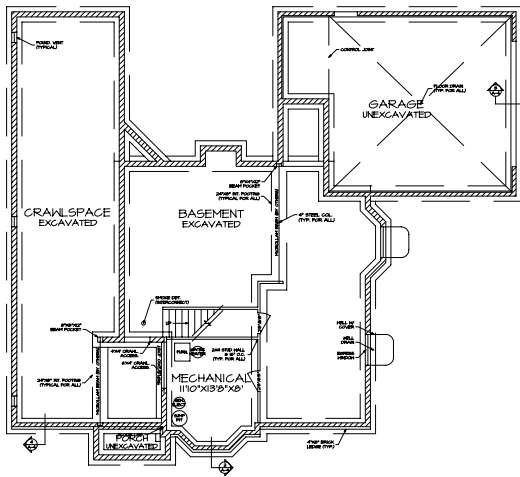

WEST ELEVATION
SCALE: 1/4"=1'-0"



FOUNDATION PLAN
SCALE: 1/4"=1'-0"

- FOUNDATION PLAN NOTES:**
1. FOUNDATION SHALL BE CONSTRUCTED IN ACCORDANCE WITH THE LATEST EDITIONS OF THE INTERNATIONAL RESIDENTIAL CODE BOOK (IRC) AND THE INTERNATIONAL FOUNDATION CODE BOOK (IFC).
 2. ALL FOUNDATION WALLS SHALL BE MINIMUM 8" THICK CONCRETE WITH REINFORCING BARS (REBAR) AT 18" ON CENTER.
 3. ALL FOUNDATION WALLS SHALL BE FINISHED WITH INTERIOR SURFACE FINISH.
 4. ALL FOUNDATION WALLS SHALL BE FINISHED WITH EXTERIOR SURFACE FINISH.
 5. ALL FOUNDATION WALLS SHALL BE FINISHED WITH INTERIOR SURFACE FINISH.
 6. ALL FOUNDATION WALLS SHALL BE FINISHED WITH EXTERIOR SURFACE FINISH.
 7. ALL FOUNDATION WALLS SHALL BE FINISHED WITH INTERIOR SURFACE FINISH.
 8. ALL FOUNDATION WALLS SHALL BE FINISHED WITH EXTERIOR SURFACE FINISH.
 9. ALL FOUNDATION WALLS SHALL BE FINISHED WITH INTERIOR SURFACE FINISH.
 10. ALL FOUNDATION WALLS SHALL BE FINISHED WITH EXTERIOR SURFACE FINISH.

STATISTICS:		D		©	
AREA:	EXISTING:	PROPOSED:			
FIRST FLOOR AREA:	N/A	2,010 S.F.			
SECOND FLOOR AREA:	N/A	1,012 S.F.			
TOTAL LIVING AREA:	N/A	3,022 S.F.			
BASEMENT AREA:	N/A	1,931 S.F.			
GARAGE AREA:	N/A	659 S.F.			
TOTAL AREA:	N/A	5,612 S.F.			

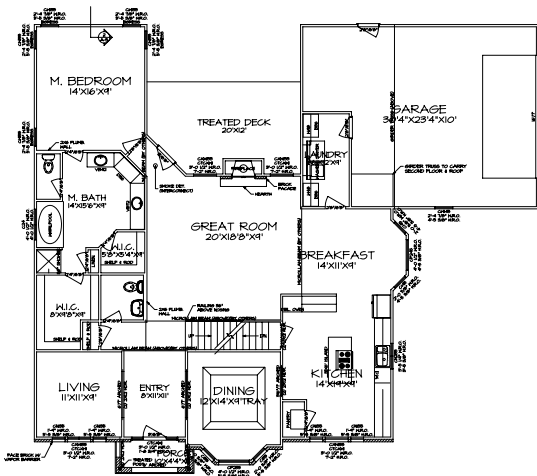

FIRST FLOOR PLAN
SCALE: 1/8"=1'-0"

- FIRST FLOOR PLAN NOTES:**
1. ALL ROOMS SHALL BE FINISHED WITH INTERIOR SURFACE FINISH.
 2. ALL ROOMS SHALL BE FINISHED WITH EXTERIOR SURFACE FINISH.
 3. ALL ROOMS SHALL BE FINISHED WITH INTERIOR SURFACE FINISH.
 4. ALL ROOMS SHALL BE FINISHED WITH EXTERIOR SURFACE FINISH.
 5. ALL ROOMS SHALL BE FINISHED WITH INTERIOR SURFACE FINISH.
 6. ALL ROOMS SHALL BE FINISHED WITH EXTERIOR SURFACE FINISH.
 7. ALL ROOMS SHALL BE FINISHED WITH INTERIOR SURFACE FINISH.
 8. ALL ROOMS SHALL BE FINISHED WITH EXTERIOR SURFACE FINISH.
 9. ALL ROOMS SHALL BE FINISHED WITH INTERIOR SURFACE FINISH.
 10. ALL ROOMS SHALL BE FINISHED WITH EXTERIOR SURFACE FINISH.

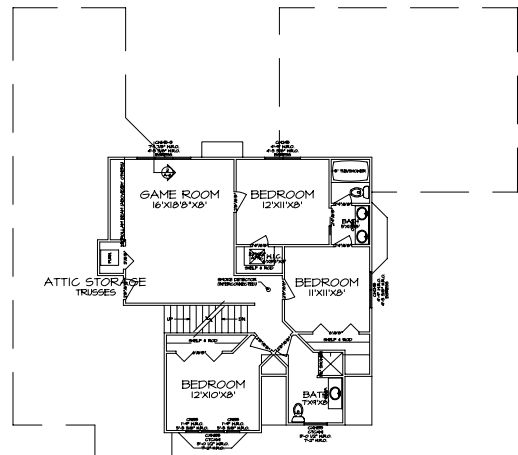

SECOND FLOOR PLAN
SCALE: 1/8"=1'-0"

- SECOND FLOOR PLAN NOTES:**
1. ALL ROOMS SHALL BE FINISHED WITH INTERIOR SURFACE FINISH.
 2. ALL ROOMS SHALL BE FINISHED WITH EXTERIOR SURFACE FINISH.
 3. ALL ROOMS SHALL BE FINISHED WITH INTERIOR SURFACE FINISH.
 4. ALL ROOMS SHALL BE FINISHED WITH EXTERIOR SURFACE FINISH.
 5. ALL ROOMS SHALL BE FINISHED WITH INTERIOR SURFACE FINISH.
 6. ALL ROOMS SHALL BE FINISHED WITH EXTERIOR SURFACE FINISH.
 7. ALL ROOMS SHALL BE FINISHED WITH INTERIOR SURFACE FINISH.
 8. ALL ROOMS SHALL BE FINISHED WITH EXTERIOR SURFACE FINISH.
 9. ALL ROOMS SHALL BE FINISHED WITH INTERIOR SURFACE FINISH.
 10. ALL ROOMS SHALL BE FINISHED WITH EXTERIOR SURFACE FINISH.